

BLANKING PLUG

NON-METALLIC Ex e

for General Industrial and Hazardous Area Installations



Features and Benefits

- Precision manufactured from Polybutylene Terephthalate (PBT).
- Used to blank off threaded entry holes.
- May be used to blank off an unthreaded entry hole if secured in place with a locknut.

Technical Data

| | |
|------------------|----------------------------------|
| Type: | Non-Metallic Blanking Plug |
| Plug Material: | Polybutylene Terephthalate (PBT) |
| Gasket Material: | EPDM |

Standards and Certifications

| | | |
|------------------------------|--|--|
| Equipment Protection Levels: | IECEX: Ex e IIC Gb, Ex nR IIC Gc, Ex tb IIIC Db ATEX: Ⓜ II2 GD, II3 GD, Ex e IIC Gb, Ex nR IIC Gc, Ex tb IIIC Db TR CU: 1Ex e IIC Gb X / 2Ex nR IIC Gc X / Ex tb IIIC Db X | |
| Conformance: | Standard: | Certificate: |
| IECEX | IEC 60079 Parts 0, 7, 15, 31 | IECEX ICS 15.0007X |
| ATEX | EN 60079 Parts 0, 7, 31 | CML 15ATEX3094X |
| | EN 60079 Parts 0, 15, 31 | CML 15ATEX4095X |
| INMETRO (Brazil) | ABNT NBR IEC 60079 Parts 0, 7, 31 | TÜV 15.1818X |
| TR CU (Russia) | ГОСТ Р М3К 60079-0, 7, 31 | TC RU C-ZA.ME92.B.00695 |
| SANS/IEC | IEC 60079 Parts 0,1, 7, 31 | MASC MS/13-594X |
| | IEC 60529 | |
| IP66/68 2m - Parallel | IEC 60529 | CML15Y728 |
| Marine ABS DNV-GL | IEC 60079 Parts 0, 1, 7, 15, 31 and IEC 60529 | ABS 14-SG1216922-PDA |
| | IEC 60079 Parts 0, 1, 7 and IEC 60529 | DNV-GL TAE0000010 DNV-GL TAE000000Z |
| London Underground | BS EN 62444 | LU3043, LU3044 |

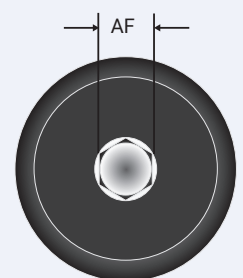
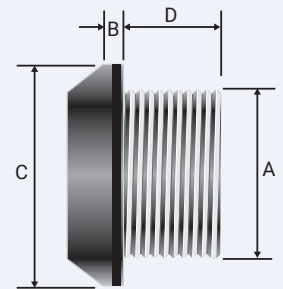

FRONT VIEW 'C'



Conditions of Safe Use - X

- The Non-metallic threaded blanking element shall only be used where the temperature, at the point of entry, is between -20°C and +95°C.
- To maintain the IP rating / restricted breathing, the end user shall ensure that the surface of the enclosure against which the sealing gasket seals, is in a good condition.

Installation instructions

- Installation should only be carried out by a competent person using the correct tools.
- Ensure that the thread type and size are compatible with the equipment being installed to.
- Fully tighten all threads.
- Non-metallic blanking plug is not repairable/reuseable.

| Product Code | Metric Dimension 'A' | Dimension Max 'B' | Dimension Max 'C' | Dimension Min 'D' | Dimension Max 'A/F' | Install. Torque Value Nm |
|--------------|----------------------|-------------------|-------------------|-------------------|---------------------|--------------------------|
| 352720 | M20x1.5 | 6.0 | 28.0 | 12.0 | 10.0 | 7.0 |
| 352725 | M25x1.5 | 6.0 | 33.0 | 15.0 | 10.0 | 9.0 |
| 352732 | M32x1.5 | 6.0 | 40.0 | 15.0 | 10.0 | 12.0 |

All dimensions are in mm