

TOOLS

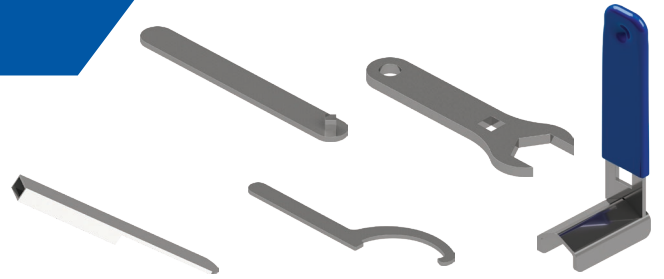

POSI SPANNER

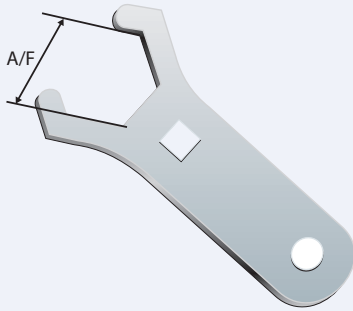

LOCKNUT SPANNER

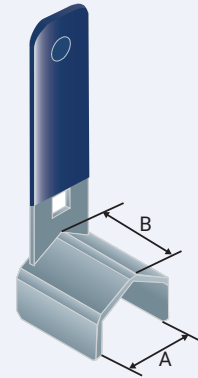

Gland Size	A/F	SPANNER PRODUCT CODE		
		Posi Flex™	Posi Grip™	Posi Braid™
00	28	401205	401205	401205
0	30	401206	401206	401206
1	34	401207	401207	401207
2	42	401208	401208	401208
3	52	401209	401209	401209
4	62	401210	401210	401210
5	74	401211	401211	401211
6	95	401212	401212	401212
7	110	401213	401213	401213
8	118	401214	401214	401214
9	130	401215	401215	401215

A/F dimensions are in mm. Refer to data sheet for installation torque value.

Spanner Product Code	Suit Gland Size	Across Flats 'A'	Depth of Reach 'B'
40162025PA60	0 / 1	25.0	60.0
40162032PA60	2	32.0	60.0
40162040PA60	3	40.0	60.0
40162052PA60	4	52.0	60.0
40162065PA65	5	65.0	65.0
40162080PA70	6	80.0	70.0
40162096PA75	7 / 8	96.0	75.0
40162111PA80	9	111.0	80.0
40162125PA85	10	125.0	85.0
40162135PA85	11	135.0	85.0

Dimensions are in mm.

C SPANNER

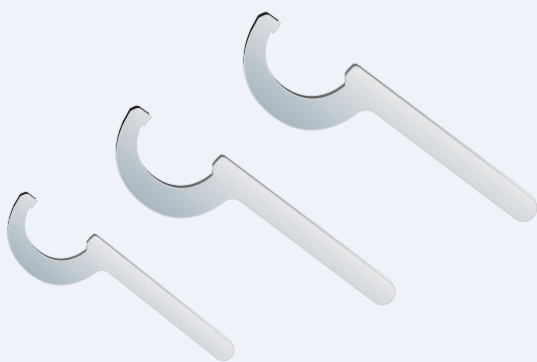

SQUARE POWER BAR

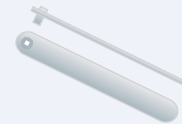

Product Code

401600-000

WIRE BENDING TOOL

FOR STEEL WIRE ARMOUR CABLE

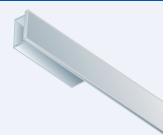

Product Code

401701

Gland Size	A2	BW	CW	D1W	E1W
10	401610	401610	401610	401610	401610
11	401611	401611	401611	401611	401611
12	401612	401612	401612	401612	401612
13	401613	401613	401613	401613	401613

Refer to data sheet for installation torque value.

SELECTION CHART HEX SPANNER



CCG HEX SPANNER SELECTION CHART

Gland Size	Hex	A2	BW	CW	D1W	E1W	IPLUS	E1EX	E1EX-U	EX-CGUARD	A2F	A2EX	ARMORTEX	FLP/FLPTR	REDUCER	ADAPTOR
00/0	24	4016-0	4016-0	4016-0	4016-0	4016-0	4016-0	4016-0	4016-0	4016-0	4016-0	4016-0	4016-0	4016-0	4016-0	4016-0
00	25	-	401600-025	401600-025	401600-025	401600-025	401600-025	401600-025	401600-025	401600-025	401600-025	401600-025	401600-025	401600-025	-	-
1	27	401601-027	401601-027	401601-027	401601-027	401601-027	401601-027	401601-027	-	401601-027	401601-027	401601-027	-	-	-	-
2	30	-	-	-	-	-	-	-	401601-030	-	-	-	401601-030	401601-030	-	-
2	32	401602-032	401602-032	401602-032	401602-032	401602-032	401602-032	-	-	-	-	-	-	-	401602-032	401602-032
2	35	401602-035	401602-035	401602-035	401602-035	401602-035	401602-035	401602-035	-	401602-035	401602-035	401602-035	-	-	-	-
2	38	-	401602-038	-	-	-	-	-	401602-038	-	-	-	-	-	401602-038	401602-038
3	40	401603-040	401603-040	401603-040	401603-040	401603-040	401603-040	-	-	-	-	-	401603-040	-	-	-
3	42	401603-042	401603-042	401603-042	401603-042	401603-042	401603-042	401603-042	-	401603-042	401603-042	401603-042	-	401603-042	-	-
3	45	-	-	-	-	-	-	-	401603-045	-	-	-	-	-	-	-
3	47	-	-	-	-	-	-	-	-	-	-	-	401603-047	-	-	-
4	52	401604-052	401604-052	401604-052	401604-052	401604-052	401604-052	401604-052	-	401604-052	401604-052	401604-052	-	-	-	-
4	55	-	-	-	-	-	-	-	401604-055	-	-	-	401604-055	401604-055	-	-
4	60	-	-	-	-	-	-	-	-	-	-	-	401604-060	401604-060	-	-
5	65	401605-065	401605-065	401605-065	401605-065	401605-065	401605-065	401605-065	401605-065	401605-065	401605-065	401605-065	-	-	-	-
5	75	-	-	-	-	-	-	-	-	-	-	-	401605-075	401605-075	-	-
6	80	401606-080	401606-080	401606-080	401606-080	401606-080	401606-080	401606-080	-	401606-080	401606-080	401606-080	-	-	-	-
6	85	-	-	-	-	-	-	-	401606-082	-	-	-	401606-082	401606-082	-	-
6	96	401606-085	401606-085	401606-085	401606-085	401606-085	401606-085	401606-085	-	401606-085	401606-085	401606-085	-	401606-085	-	-
7/8	112	401607-096	401607-096	-	401607-096	-	-	401607-096	401607-096	401607-096	401607-096	401607-096	-	-	-	-
9	126	-	-	-	-	-	-	401609-112	401609-112	401609-112	401609-112	401609-112	-	-	-	-
10	136	-	-	-	-	-	-	401610-126	401610-126	-	401610-126	401610-126	-	-	-	-
11	-	401611-136	401611-136	401611-136	-	-	-	-	-	-	-	-	-	-	-	-
12	-	401612-137	401612-137	401612-137	-	-	-	-	-	-	-	-	-	-	-	-
13	-	401613-148	401613-148	401613-148	-	-	-	-	-	-	-	-	-	-	-	-